

EXAVIZ Interceptor Carrier Board v2

- J8 - four port RJ-45 switch
- J4 and J5 - two full-size HDMI ports
- J6 - two port USB 2.0 connector
- J3 - single port RS-485 connector
- J7 - 9-pin header for two additional USB 2.0 connections
- J1 - ATX power connector
- M1 thru M4 - 12v 3-pin fan connectors
- J11 thru J15 - SATA drive connections
- J2 - 8-pin header for system power LED, power-on button and UART serial cable
- J9 and J10 - FFC (40 pos) connections for future expansion
- BT1 - Battery for the Real Time Clock. 3V CR2032
- U18 - Micro SD Card Slot
- D1 - Blue LED - ATX Power on
- D2 - Yellow LED - CM4 3.3v out
- D3 - Green LED - CM4 Activity
- J16 - SD Card boot for Rockchip CMs, jumper on pins 1 & 2. (Not currently supported)

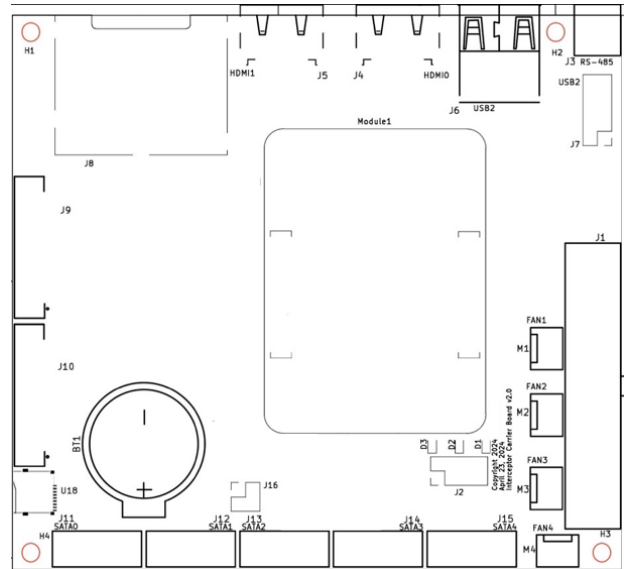

- An Operating System (OS) Image with all necessary drivers is provided by EXAVIZ and can be downloaded via: https://www.exaviz.com/interceptor_os_latest.img.gz

Requirements

Raspberry Pi4 bootloader version 2020-12-14 or newer is required to install the EXAVIZ provided OS Image via USB flash drive.

You must use an ATX Power Supply Unit (20 or 24 pin) that can provide stable +3.3V (contact support@exaviz.com for suggestions).

Notes

Port A is WAN (Client accepts IP from network)

Ports B, C, and D are, by default, LAN (EXAVIZ OS Provided DHCP Server sets IP for each)

The 8-pin header (J2) pins, starting with the bottom left pin (and the pin above it): 1 (+) & 2 (-) are for the power LED, then moving right 3 & 4 are for "power on" button, 5 (tx) & 6 (rx) are for UART serial cable, and 7 & 8 are ground. See image for pin layout →

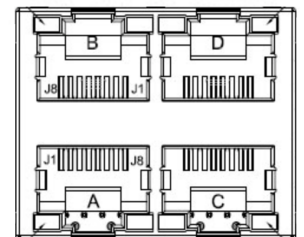

2468
1357

The "power on" pins/button will not function on the Banana Pi CM4 board due to compatibility issues on their side. Also, HDMI1 is unsupported when using a Banana Pi CM4 board.

Warranty/Support

Axzez circuit boards include a 90-day Warranty from the date of purchase covering manufacturing defects.

If you need support or have questions, please contact support@exaviz.com.